

ANL Fuse



20A | 30A | 40A | 60A

100A | 200A | 300A | 400A

Version 1.4

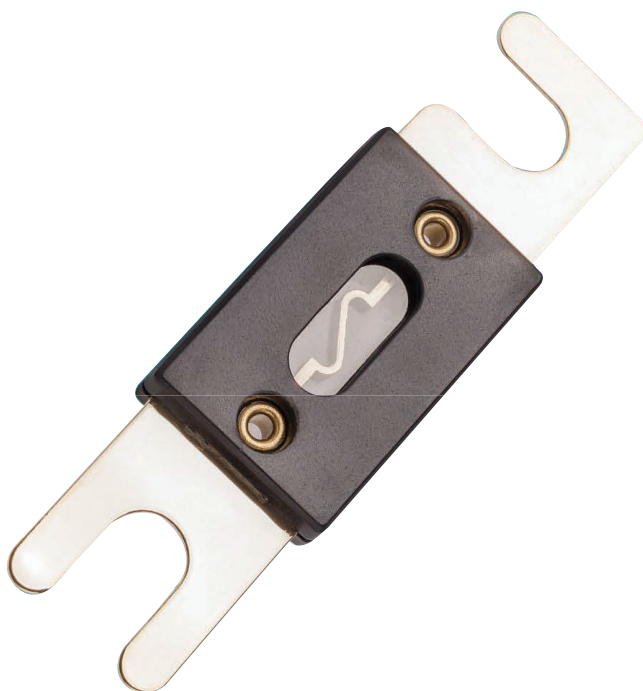

General Information

Key Features

- Gold/Nickel plated terminal contact for corrosion resistance
- Ignition protected
- Visible through clear window to easily identify open status
- For use with RENOGY ANL Fuse Block
- RoHS compliant

Dimension

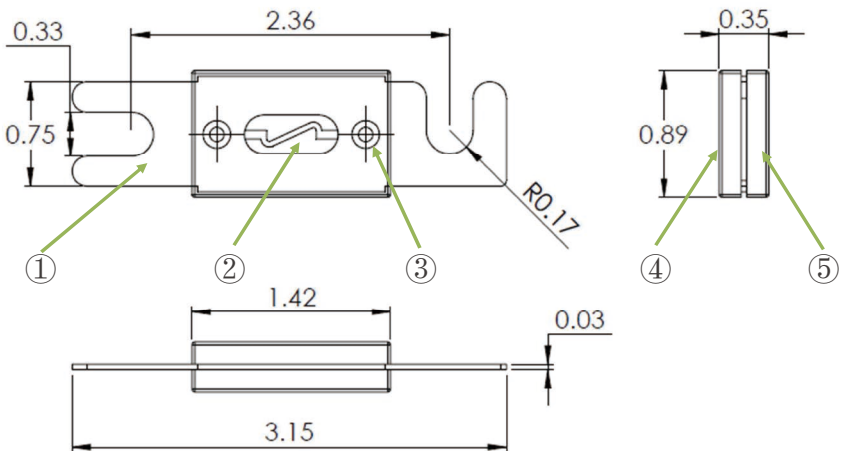

Dimensions in inches.

Components

Item	Description	QTY	Material	Remarks
1	Terminal Contact	1	Alloy	Au/Ni Plates
2	Transparent Cover	1	IS-3PC	Transparent
3	Connector	2	Brass Copper	Natural
4	Plastic Cover	1	Bakelite	Black
5	Plastic Base	1	Bakelite	Black

Technical Specifications

Electrical Parameters

Product	Current Rating	Voltage Rating	Interrupt Capacity
ANL-FUSE20	20A	72V	40A
ANL-FUSE30	30A	72V	60A
ANL-FUSE40	40A	72V	80A
ANL-FUSE60	60A	72V	120A
ANL-FUSE100	100A	72V	200A
200ANL	200A	72V	400A
300ANL	300A	72V	600A
400ANL	400A	72V	800A

Mechanical Parameters

Dimension	3.15 x 0.89 x 0.35 inches	80.0 x 22.5 x 8.7 mm
Weight	0.07 lbs / 31.75 g	

Standard: DIN43560/1

Functional Characteristics

A fuse does not blow when the current reaches its rated current. It is designed to pass its rated current without opening. A fuse will take varying times to blow under different conditions. A fuse will pass significantly more than its rated current for a very short time. The times for other fuses will be slightly different.



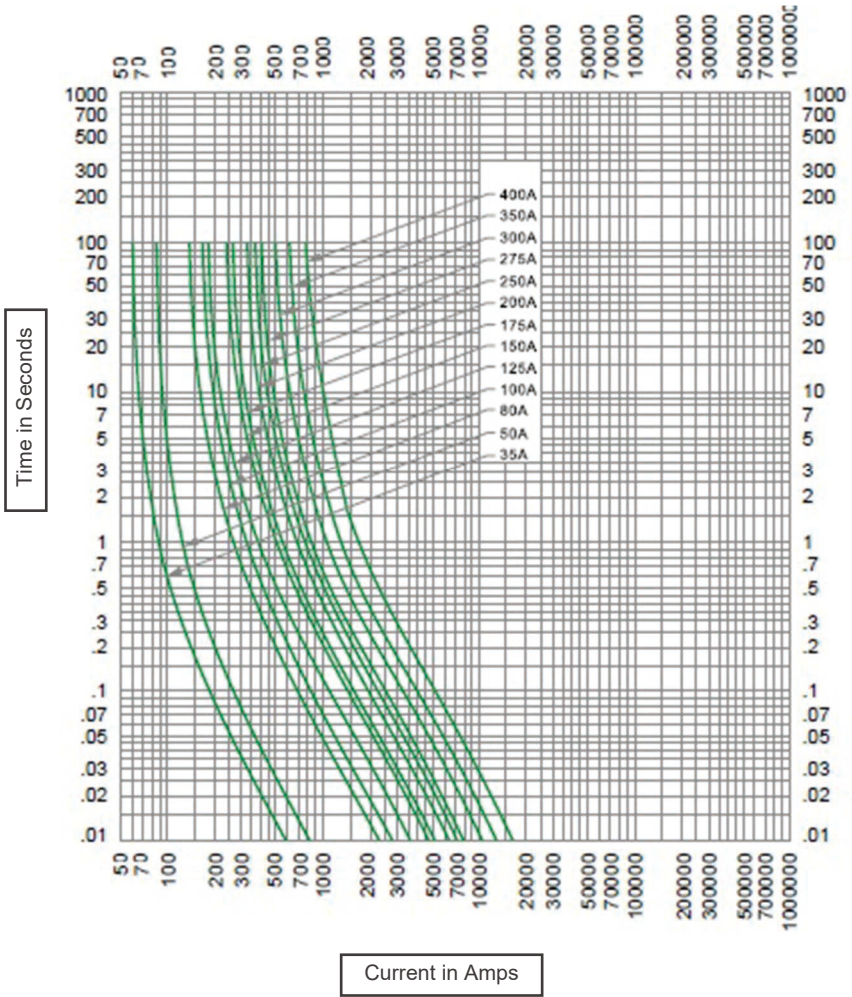

Testing Current (% of amp rating)	Blow Time Limit
150% (Rating<225A)	1Hr. minimum
160% (Rating>225A)	6 seconds minimum
220%	60 seconds Max.
250%	0.8sec-10sec
400%	0.2sec-2sec

Components

Time-current curves - average melt:





Renogy reserves the right to change the contents of this manual without notice.



US |  2775 E Philadelphia St, Ontario, CA 91761, USA
 909-287-7111
 www.renogy.com
 support@renogy.com

CN |  苏州高新区科技城培源路1号5号楼-4
 400-6636-695
 <https://www.renogy.cn>
 support@renogy.cn

JP |  <https://www.renogy.jp>
 supportjp@renogy.com

CA |  <https://ca.renogy.com>
 supportca@renogy.com

AU |  <https://au.renogy.com>
 supportau@renogy.com

UK |  <https://uk.renogy.com>
 supportuk@renogy.com

DE |  <https://de.renogy.com>
 supportde@renogy.com